

Alexd. McIntosh

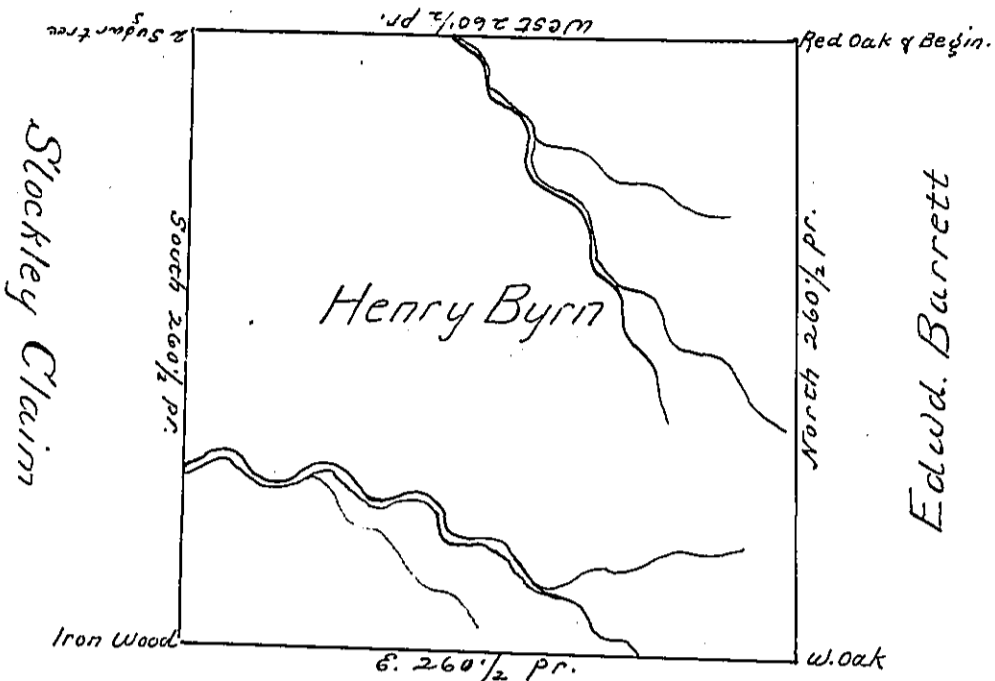

John Thomsons

The above is a Draught of a Survey made March 27th. 1785, In pursuance of a warrant granted to Henry Byrn dated. Sept. 13th. 1784 Situate on Water of Wheeling Creek call'd Sugar Loaf containing 400 acres & allowance of 6 percent for Roads &c.

Jno Hoge S.S.

John Lukens Esqr  
S. G.

IN TESTIMONY that the above is a copy of the original remaining on file in the Department of Internal Affairs of Pennsylvania, made conformably to an Act of Assembly approved the 16th day of February, 1833, I have hereunto set my Hand and caused the Seal of said Department to be affixed at Harrisburg, this fourth day of November 1902

*James W. Latta*  
Secretary of Internal Affairs.